

**BURG®**

FLEXO



CLOUD

# FLEXO

## CLOUD

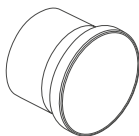

### RetroFit

Simple, fast and efficient replacement of existing locking systems thanks to the 16 mm x 19 mm standard mounting hole.



### FlushFit

The Flexo flush-fit is recessed into the furniture front and screwed in place with the Flexo.ring. The locking system stands out discreetly from the door front.



### Many options

The Flexo can be used with all BURG steel cams. The installation of the locking system does not differ from purely mechanical solutions.

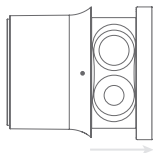

### Battery drawer

The batteries can be changed from the outside without having to unlock the lock or the user having to be on site. The data will not be deleted in the process.

# High-quality variety

The cloud products are innovative locking system solutions with outstanding cloud functionality, enabling convenient operation via card or app (iOS and Android). Operation via app, which also serves as a gateway, is particularly popular - a separate gateway is therefore not required.

The cloud solution is also compatible with other BURG products, such as the Flexo Q. Specially requested functions can be adapted or newly integrated in the software.

## Features

- four different operating modes
- easy assignment of operation rights via the app
- logging of locking processes in the cloud
- RFID standards: MIFARE® Classic, MIFARE® DESFire® EV, LEGIC®, ...
- possibility of operation via Bluetooth® and RFID cards



# Operation modes



## **Multi-user mode**

Several users can use different locks. Operation is via a user card or smartphone. Saved locking information gets deleted during the opening process. One user card can lock several locks at the same time.



## **Private mode light**

The lock is permanently personalized and therefore permanently assigned to a user. It can only be operated using the personalized user card. A one user can use any number of locks in this mode with this user card.



## **Private mode (App)**

The lock is permanently personalized in the app and can then be operated via the app or with the user card stored in the profile. Other users cannot operate the lock. This mode is a requirement for shared private mode.

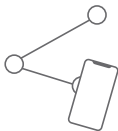

## **Shared private mode (App)**

If the lock is in private mode, it can be shared with one or more people. The lock remains in the possession of the person to whom it is personalized. This person can assign and delete the usage rights in the app.



**BURG Lüling GmbH & Co. KG**

Volmarsteiner Str. 52 • 58089 Hagen (Germany)  
info@burg.de • +49 (0) 2335. 63 08-0

**Follow us on LinkedIn**  
With our news and updates we  
keep you always up to date.



[www.burg.de](http://www.burg.de)