

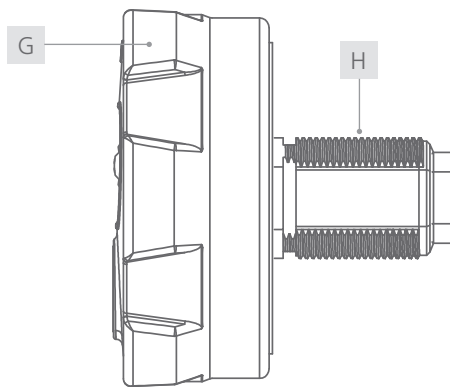

## sPinLock200 Operating Manual

## sPinLock 200

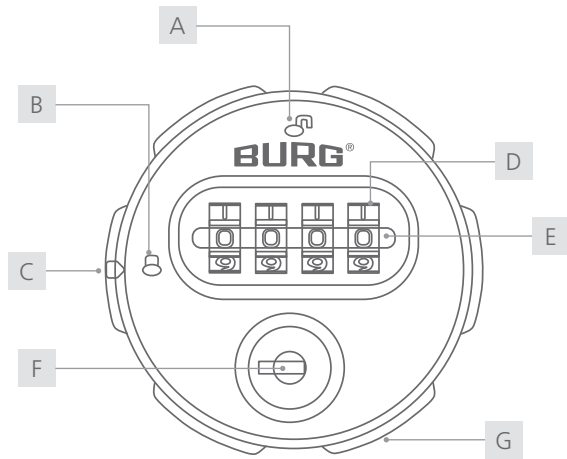

- |                      |                      |
|----------------------|----------------------|
| A lock symbol open   | B lock symbol closed |
| C locking indication | D number wheels      |
| E guide line         | F keyhole            |
| G knob               | H stator             |

## Content

General.....	2
Technical data.....	3
Default settings.....	3
Scope of delivery.....	3
Optional accessories.....	3
Mounting dimensions.....	3
Product dimensions.....	3
Functional description.....	4
Configuration.....	4
Operation.....	5
Assembly.....	5 - 6
Guarantee and warranty.....	6
Contact.....	6

## General

The latest version of this guide is available at:  
[www.burg.de](http://www.burg.de)

### Important notes:

Please observe all important notes and read the entire operating manual before starting the configuration.

## Factsheet



### Technical Data

Dimension	107 x 56 x 13 mm
Material	housing: Plastic stator: Zamak
Mounting dimension	16 mm x 19 mm
Max. door thickness	18 mm
Lock attachment	M19 nut (1x)
Cam type	B
Door hinge side	DIN right
Locking rotation	90°
Mode	multi-user mode
Number wheels	4
No. of possible codes	9,999

### Default settings

Code	0-0-0-0
------	---------

### Scope of Delivery

- 1x locking system
- 1x cam fixing screw <sup>1</sup>
- 1x M19 nut
- 1x cam type B

### Optional Accessories

- Master key
- Anti-twist protection

<sup>1</sup> The use of a screw with a different length may cause damage to the lock.

<sup>2</sup> Mounting dimensions and templates (STEP files) for milling, punching or lasering can be requested from BURG.

### Mounting dimensions<sup>2</sup>

All dimensions are in millimeters.

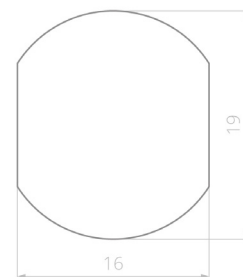

### Product dimensions<sup>2</sup>

All dimensions are in millimeters.

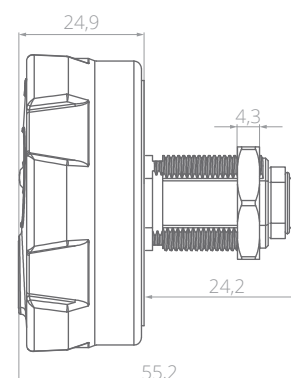
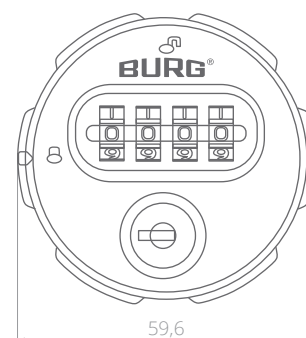

## Functional Description

### Mode: multi-user authorization (multi-user mode)

This mode is suitable for changing user groups where the locker is only used temporarily or once, e.g. in a sports facility. Codes are valid for a single locking process and are deleted from the lock when the compartment is reopened. The lock remains open until a new code locks the lock again.

### Master key

By using the master key, you can read the current code and reopen the lock (code finding).

*Note: The master key is not included. If needed, it can be ordered separately.*

## Operation

### 1 Lock

1. Turn the knob to open position.

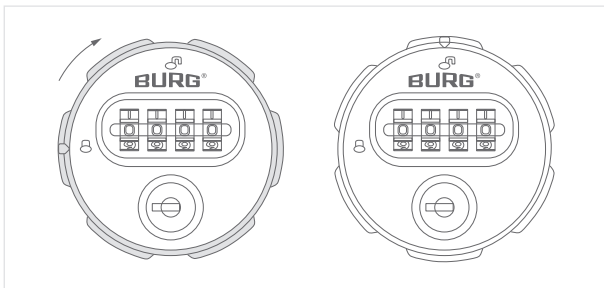

2. Set code.

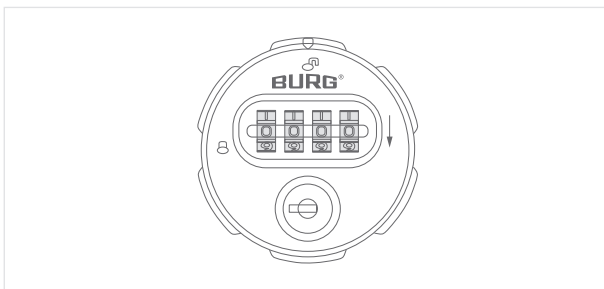

3. Turn the knob to closed position.

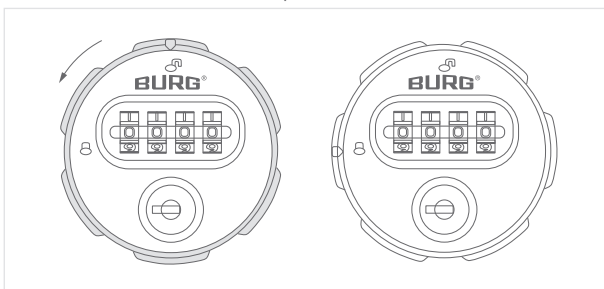

3. Turn the number wheels to lock.

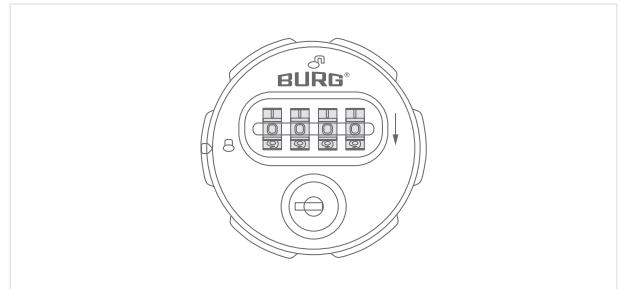

### 2 Unlock

1. Set current code.

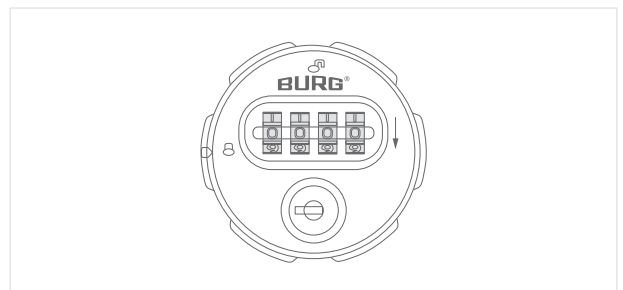

2. Turn the knob to open position.

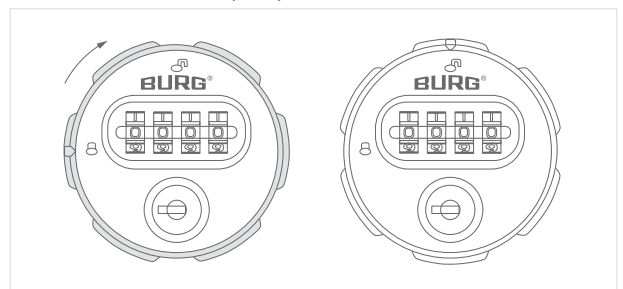

## Code finding via master key

1. Insert the master key and turn it 90° to the right.

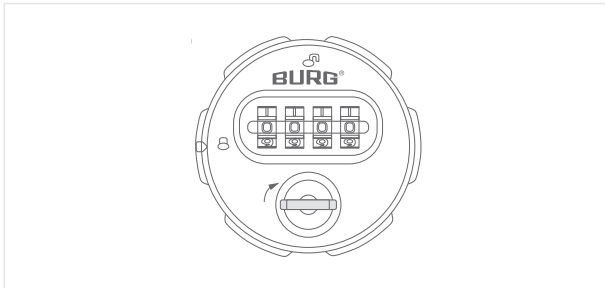

2. Turn the number wheels from top to bottom until each one locks into place. The valid code can then be read.

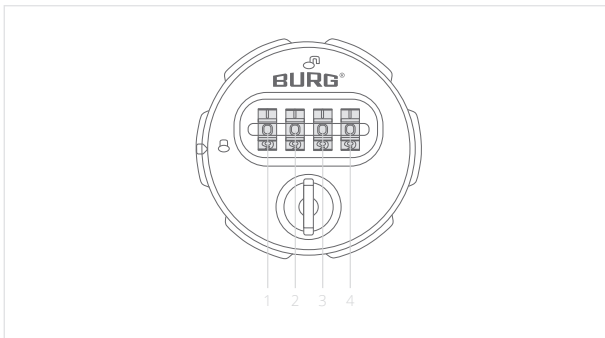

3. Turn the master key 90° to the left and remove it.

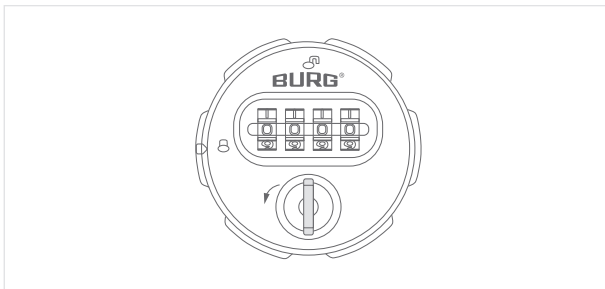

4. Turn the knob to open position.

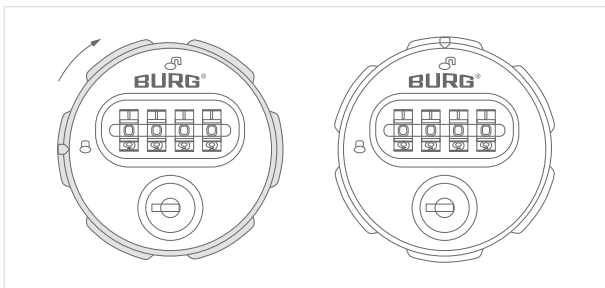

## Assembly

Mounting dimensions and templates (STEP files) for milling, punching or lasering can be requested from BURG.

1. Prepare the mounting holes on the door front according to the installation dimensions (dimensions on p. 3).

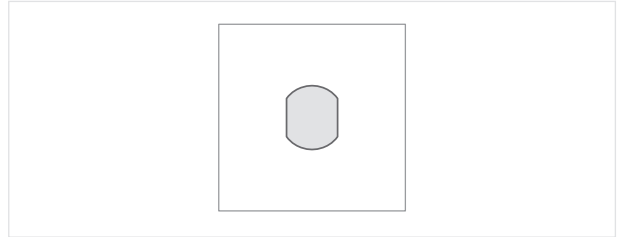

2. Insert the lock from the front (outside of the door) into the mounting hole and hold it in this position. The lock must be straight and the BURG logo must be at the top.

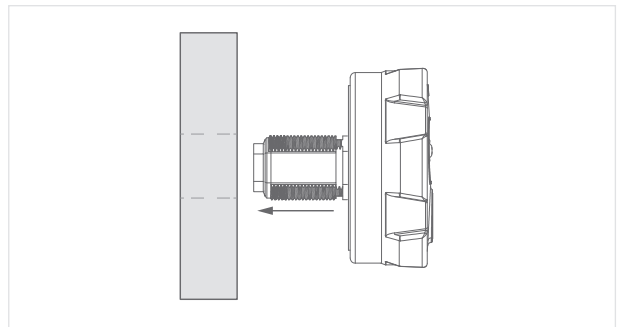

3. Place the M19 nut on the stator from behind and tighten hand-tight using a socket wrench (SW22).

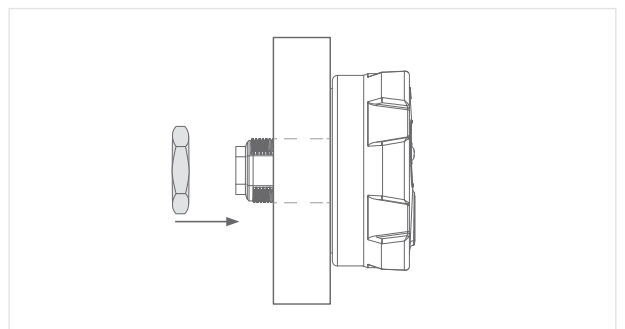

- 4 Attach the cam. Tighten it with the cam fixing screw by hand using a cross-head screwdriver (e.g., size PH 2).

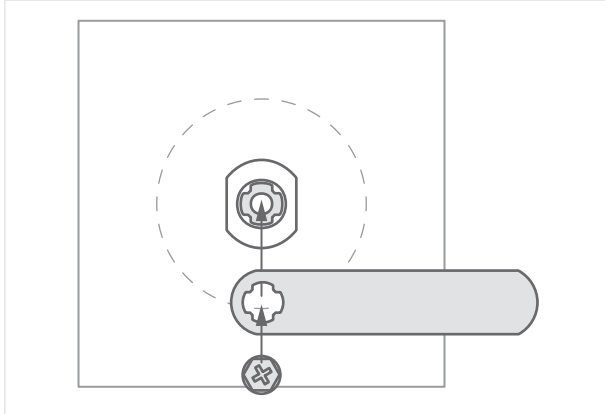

- 5 Check whether the cam is securely held in place on the strike plate or rebate when closed. When closing the locking system, it should be possible to turn the cam to its end position without applying pressure or resistance.

*Note: An adjustable strike plate allows for optimal adjustment of the closing mechanism. More information can be requested from BURG.*

## Guarantee and Warranty

The warranty is subject to the statutory provisions. If you have any questions, please contact a specialist dealer or use the contact details below.

## Contact

### **BURG Lüling GmbH & Co. KG**

Volmarsteiner Str. 52  
58089 Hagen (Germany)  
+49(0)23 35 63 08-0

info@burg.de  
www.burg.de