

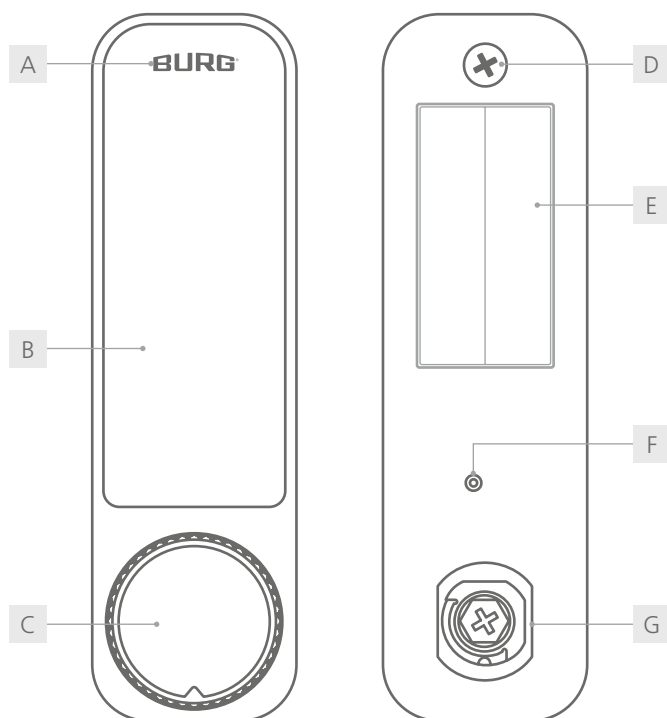

Niro.RFID

Operating Manual

Niro.RFID



- | | |
|-----------------------|----------------|
| A LED | B RFID antenna |
| C knob | D fixing screw |
| E battery compartment | F reset hole |
| G stator | |

General

The latest version of this guide is available at:
www.burg.de

Important notes:

- Please observe all important notes and read the entire operating manual before starting the configuration.
- Before putting the locking system into operation, refer to "Commissioning" on page 7.
- Master cards must be kept in a safe place. If lost, no further configurations can be made.
- The control panel is supplied with a protective film. **The protective film should be removed during commissioning.**

Content

General.....	2
Technical data.....	3
Default settings.....	3
Scope of delivery.....	3
Optional accessories.....	3
Features.....	3
Product dimensions.....	4
Mounting dimensions.....	4
Product variations.....	5
Functional description.....	6
LED & sound signals.....	6
Guarantee of transponder compatibility.....	6
Commissioning.....	7
Configuration.....	7 - 8
Operation.....	9
Assembly.....	10
Battery change.....	11
Disposal and battery note.....	12
Information on battery life.....	12
Conformity / Certification.....	12
Guarantee and warranty.....	12
Cleaning and care instructions.....	12
Contact.....	12

To the video:
operation

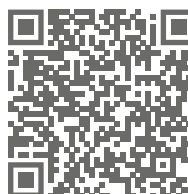

To the video:
assembly

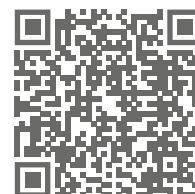

For online viewing, click on QR codes.

¹ Primary representation in the operating manual is vertical. For optional product variants, see p. 5.

Factsheet

Front view

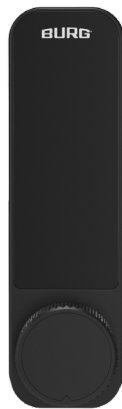

Back view



Technical Data

Variations	vertical, horizontal right / left
Dimension	132 x 38 x 31.5 mm
Battery ¹	VARTA ¹ AAA (2x)
Locking cycles	up to 50,000 ²
Stand-by time	approx. 2 years
Material	housing: zamak stator: steel
Humidity (rel.)	0% - 95%
Temperature range	working temperature: -10°C to 50°C storage temperature: -15°C to 60°C
Degree of soiling	2
IP class	IP65
Application area	indoor / outdoor
Mounting dimension	stator: 16 mm x 19 mm screw: Ø 5 mm
Max. door thickness	22 mm
Lock attachment	M19 nut (1x) wood or steel screw M4 (1x)
Cam type	B
Locking direction adjustable	left (90°) / right (90°) see p. 10
Mode	multi-user mode (default), private mode
RFID types ³	MIFARE® Classic (read / write), MIFARE® DESFire® EV (read) ISO/IEC 14443 Typ A (13,56 MHz)
No. of master cards	max. 3
No. of manager cards	max. 2
No. of user cards	max. 10 (V1.0) / max. 500 (V1.1) ⁴

Default Settings

Mode	multi-user mode
Occupancy identification	on

Scope of Delivery

- 1x locking system
- 1x rubber seal
- 1x M19 nut
- 1x steel screw M4 x 10 mm ⁵
- 1x wood screw M4 x 28 mm ⁵ (for door thicknesses from 18 mm - 22 mm)
- 1x cam fixing screw (M5 x 5,8 mm)
- 1x locking direction disk

Optional Accessories

- battery (VARTA ¹ AAA)
- master card / manager card (assigned)
- user card
- reset pin
- sector card set (sector 0 to sector 15)
- master key
- magnet for emergency opening
- cam type B (order-related)

¹ The lock is approved for VARTA brand batteries. The use of other batteries may lead to malfunctions (s. point „battery note“).

² Test value for consecutive locking cycles with one set of VARTA batteries. In everyday use, factors such as usage profile, temperature-dependent self-discharge, battery quality, and the standby current of the electronics limit the achievable number of cycles. The actual number may therefore vary. For further information, see p. 12 "Information on battery life".

³ Please note the point "Guarantee of transponder compatibility" (s. p. 5).

⁴ In private mode, up to 500 user cards can be taught in, starting with V1.1.

⁵ The use of a screw with a different length may cause damage to the lock.

Features

- housing made of sturdy zamak with black powder coating
- RFID types: MIFARE® Classic / MIFARE® DESFire® EV
- integrated occupancy identification with MIFARE® Classic
- easy to retrofit (e.g. to replace mechanical locks)
- IP65 protection (protection against dust and water jets)
- battery warning (visual and audible)
- option for mechanical emergency opening via master key

Mounting Dimensions ¹

All dimensions are in millimeters.

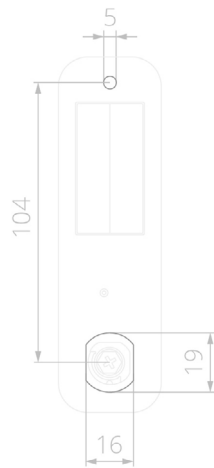

Product Dimensions ¹

Front view vertical

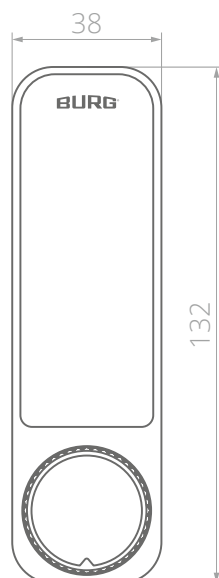

Front view horizontal left (door hinge: DIN left)

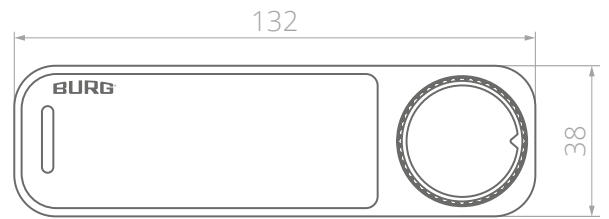

Front view horizontal right (door hinge: DIN right)

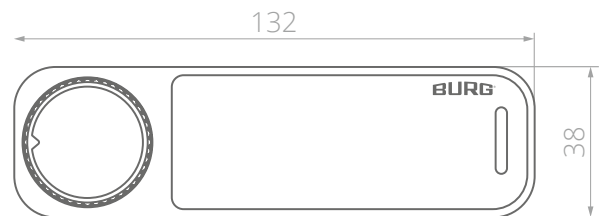

Back view

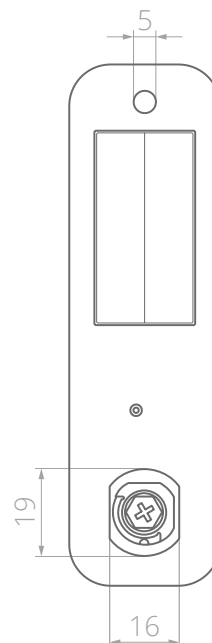

Side view

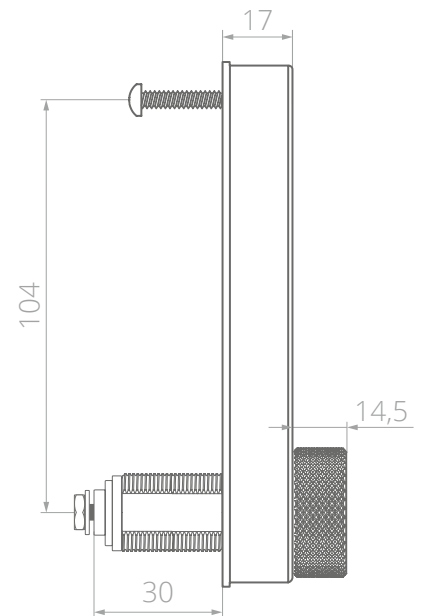

¹ Mounting dimensions and templates (STEP files) for milling, punching or lasering can be requested from BURG.

Product variations

Niro.RFID vertikal



Niro.RFID horizontal right (door hinge: DIN right)



Niro.RFID horizontal left (door hinge: DIN left)



Functional Description

Mode: multi-user authorization (multi-user mode)

This mode is suitable for changing user groups where the locker is only used temporarily or once, e.g. in a sports facility. Transponder media are valid for a single locking process and are deleted from the lock when the compartment is reopened. The lock remains open until a new transponder medium locks the lock again.

Mode: fixed assigned authorization (private mode)

In this mode, a transponder medium is preset with which the lock can be operated. This mode is suitable for user groups where the usage rights should not change permanently, e.g. for an office cabinet. The lock can only be operated with a stored transponder medium. Transponder media that are not stored are rejected by the lock.

Master card

The master card can open the lock regardless of the set mode (emergency opening). In multi-user mode, the transponder medium used for locking is deleted from the lock. The master card also authorizes the programming of master, manager and user cards (in private mode).

Manager card

The manager card can unlock the lock regardless of the set mode (emergency opening).

LED locking indication (for multi-user mode)

If the lock is locked, the red LED flashes at short intervals.

Automatic locking (for private mode)

After unlocking, the lock locks automatically after a few seconds.

Occupancy identification (for multi-user mode)

During the locking process, the transponder medium used for locking is assigned an occupancy identification. The occupancy identification prevents the transponder medium from locking another lock. The occupancy identification is canceled again during the opening process.

Note: This function is only possible with MIFARE® Classic transponder media. The occupancy identification can also be deleted from the transponder medium using the master card or the release box (e.g. after opening with a master card or manager card).

Battery warning

If the battery voltage falls below a certain level, five descending tones will sound when the code is entered and the red LED will flash several times. The lock will remain operable, but the batteries should be replaced as soon as possible. If the voltage continues to fall into the critical range, the lock will no longer be operable.

LED & Sound Signals

Green and red LED (1x flashing) / signal tone (2x short)

Batteries inserted successfully. The lock is ready for operation.

Green LED (flashes briefly) / signal tone (1x short)

Acceptance of authorized transponder media.

Red LED (2x flashing) / signal tone (2x short)

Rejecting unauthorized transponder media.

Green LED (2x flashing) / signal tone (2x long)

Successful deletion process.

Green LED (flashing) / signal tone (1x short)

Successful configuration process.

Green LED (4x flashing) / signal tone (4x short)

Successful reset process.

Red LED (2x flashing) / signal tone (2x short)

Canceling the configuration process.

Red LED (flashes briefly) / signal tone (5x short) during the opening process

Battery power decreases.

Green LED (flashing)

The lock is in configuration mode.

Red LED (flashing)

The lock is locked.

Guarantee of Transponder Compatibility

When using RFID transponder media that have not been approved by BURG, no guarantee of compatibility is given.

Commissioning

- The first card that is held in front of the lock during commissioning or after deleting the cards / resetting is stored as the **master card**.
- We recommend to assign all 3 master cards during commissioning and keeping the master cards in a safe place.
- The control panel is supplied with a protective film. The protective film can be removed during commissioning.

1 First steps

1. Remove the lock from the packaging, remove the protective film from the control panel and open the battery compartment (for help, see page 10 "Battery change").
2. Insert the batteries according to the (+ / -) symbols. Wait for the sound signal, the green and then the red LED. Close the battery compartment.
3. Hold the **master card** to be assigned centrally in front of the lock. A beep and the green LED confirm the successful process.

Note: To assign further master cards, follow point 1a - "Further master cards" in the chapter "Configuration".

Configuration

Unauthorized cards are rejected by the lock with two sound signals and the red LED flashing twice.

1 Assign cards

a) Further master cards

1. Hold the master card **2x** centrally in front of the lock. The first time the card is held in front of the lock, a beep sounds and the green LED lights up. The lock is now unlocked. When the card is held in front of the lock again, a short beep sounds and the green LED starts to flash.
2. Hold the master card to be assigned centrally in front of the lock. A long beep confirms the successful process.
3. If required, hold further master cards in front of the lock while flashing.
4. Wait until the LED stops flashing.

Note: Max. 3 master cards can be assigned.

b) Manager card

1. Hold the master card **4x** centrally in front of the lock. The first time the card is held in front of the lock, a beep sounds and the green LED lights up. The lock is now unlocked. When the card is held in front of the lock again, a short beep sounds and the green LED starts to flash.
2. Hold the manager card to be assigned centrally in front of the lock. A long beep confirms the successful process.
3. If required, hold further manager cards in front of the lock while flashing.
4. Wait until the LED stops flashing.

Note: Max. 2 manager cards can be assigned.

c) User card (private mode)

1. Hold the master card **3x** centrally in front of the lock. The first time the card is held in front of the lock, a beep sounds and the green LED lights up. The lock is now unlocked. When the card is held in front of the lock again, a short beep sounds and the green LED starts to flash.
2. Hold the user card to be assigned centrally in front of the lock. A long beep confirms the successful process.
3. If required, hold further user cards in front of the lock while flashing.
4. Wait until the LED stops flashing.

Note: Max. 10 user cards can be assigned.

2 Delete cards

a) Master card

During this process, all master cards, except the master card used for deletion, are deleted from the lock. This means that one master card always remains programmed.

1. Hold the master card **approx. 8 seconds** centrally in front of the lock. A beep sounds and the green LED lights up. The lock is now unlocked. After 8 seconds, another beep sounds and the green LED starts to flash.
2. Hold the master card that is not to be deleted centrally in front of the lock.
3. Two beeps and the green LED flashing twice confirm the successful process.

b) Manager card

During this process, all manager cards are deleted from the lock.

1. Hold the master card **approx. 8 seconds** centrally in front of the lock. A beep sounds and the green LED lights up. The lock is now unlocked. After 8 seconds, another beep sounds and the green LED starts to flash.
2. Hold any assigned manager card centrally in front of the lock.
3. Two beeps and the green LED flashing twice confirm the successful process.

c) User card (private mode)

During this process, all user cards are deleted from the lock.

1. Hold the master card **approx. 8 seconds** centrally in front of the lock. A beep sounds and the green LED lights up. The lock is now unlocked. After 8 seconds, another beep sounds and the green LED starts to flash.
2. Hold any assigned user card centrally in front of the lock.
3. Two beeps and the green LED flashing twice confirm the successful process.

3 Change mode

The **reset pin** is required for this process. The lock must be dismantled for this process (for help, see p. 9 "Assembly").

1. Dismantle the lock.
2. Press the reset pin into the reset hole on the back of the lock **3x** in succession.
3. A long beep and the red LED flashing three times for private mode (the lock is locking) or a long beep and the green LED flashing twice for multi-user mode (the lock is unlocking) confirm the successful operation.

4 Delete occupancy identification from user card

a) Via Release Box

The **Release Box** is required for this process. The user card can be used again after deletion.

1. Hold the user card centrally on the release box.
2. A beep and the green and then the blue LED¹ confirm the successful process.

b) Via master card (multi-user mode)

1. Hold the master card **3x** centrally in front of the lock. The first time the card is held in front of the lock, a beep sounds and the green LED lights up. The lock is now unlocked. When the card is held in front of the lock again, a short beep sounds and the green LED starts to flash.
2. Hold the occupied user card centrally in front of the lock. A long beep and the red LED confirm the successful process. The lock is locked.
3. Hold the user card centrally in front of the lock. The lock unlocks. A beep and the green LED confirm the successful process.

5 Set the occupancy identification

a) Change sector for the occupancy identification

The **sector card set** is required for this process. By default, the occupancy identification is written to sector **15**.

1. Hold the required sector card (sector card **1** to **15**) centrally in front of the lock.
2. Two long beeps and the green LED confirm the successful process.

b) Deactivate occupancy identification

The **sector card set** is required for this process.

1. Hold the sector card **0** centrally in front of the lock.
2. Two long beeps and the green LED confirm the successful process.

6 Reset to default settings

The **reset pin** is required for this process. The lock must be dismantled for this process (for help, see p. 9 "Assembly"). During this process all settings are reset to the default setting. All stored cards and transponder media are deleted.

1. Dismantle the lock.
2. Press the reset pin into the reset hole on the back of the lock for a few seconds.
3. Four beeps and the green LED flashing four times confirm the successful process.

¹ LED signal may differ for older release boxes.

Operation

Unauthorized cards are rejected by the lock with four shortbeeps and the red LED flashing 8 times.

1 Multi-user mode

a) Lock

1. Close the door. Turn the knob back to the starting position.
2. Hold the user card centrally in front of the knob. A beep and the red LED confirm the successful process.

b) Unlock

1. Hold the user card centrally in front of the knob. A beep and the green LED confirm the successful process.
2. Turn the knob to the open position and pull the door open.

2 Private mode

a) Unlock

1. Hold the user card centrally in front of the lock. A beep and the green LED confirm the successful process.
2. Turn the knob to the open position and pull the door open.

b) Lock

The lock locks automatically within a few seconds. The red LED flashes briefly and a beep sounds. To close, press the door shut and turn the knob back to the starting position until it clicks into place.

3 Unlock via master card / manager card

During this process, the user card used for locking is deleted from the lock in multi-user mode. If the occupancy identification is activated, it can no longer be used until the occupancy identification is canceled. In private mode, the assigned user cards are retained.

1. Hold the master card or manager card centrally in front of the lock. A beep and the green LED confirm the successful process.
2. Turn the knob to the open position and pull the door open.

4 Unlock via master key

The **master key** and a magnet are required for this process.

1. Use the magnet to remove the knob cover.
2. Insert master key and open lock.
3. Turn the master key back, remove it and replace the knob cover.

Assembly

Mounting dimensions and templates (STEP files) for milling, punching or lasering can be requested from BURG.

- 1 Prepare the mounting hole according to the mounting dimensions (measurements on p. 4).

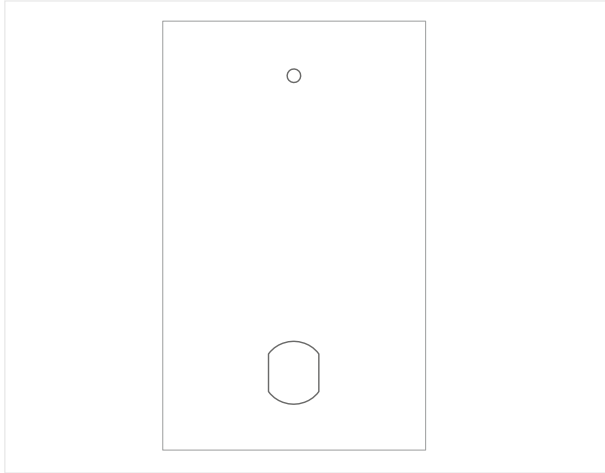

- 2 Insert the lock into the mounting hole from the front (outside of the door) and hold it in this position. Make sure that the BURG logo is at the top of the lock. Place the M19 nut on the stator from behind and tighten hand-tight using a socket wrench (SW22). Insert the fastening screw above the lock through the hole provided and screw it to the lock using a Phillips screwdriver (e.g. size PH 2).

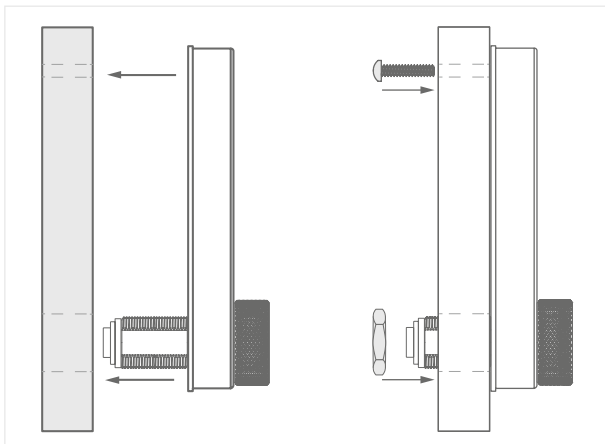

- 3 Set the locking direction if required. On delivery, the locking direction is set to "left" (door hinge: DIN right). The locking direction can be adjusted in 90° steps. To do this, remove the locking direction disk from the stator, turn it 90° to the right and replace it.

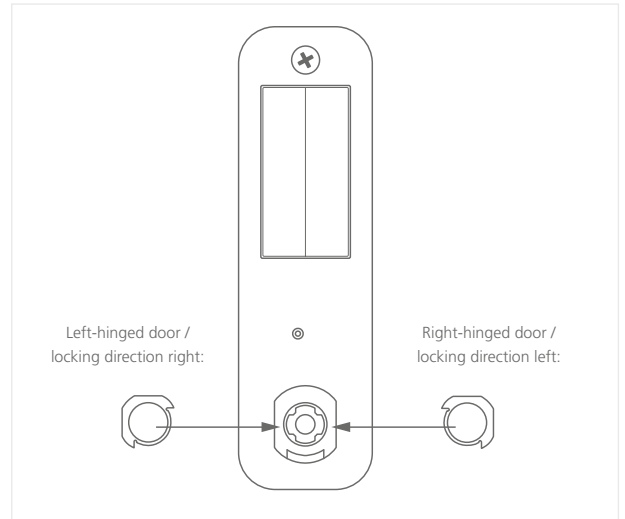

- 4 Fit the cam and tighten it hand-tight using the enclosed cam fixing screw and a Phillips screwdriver (e.g. size PH 2).

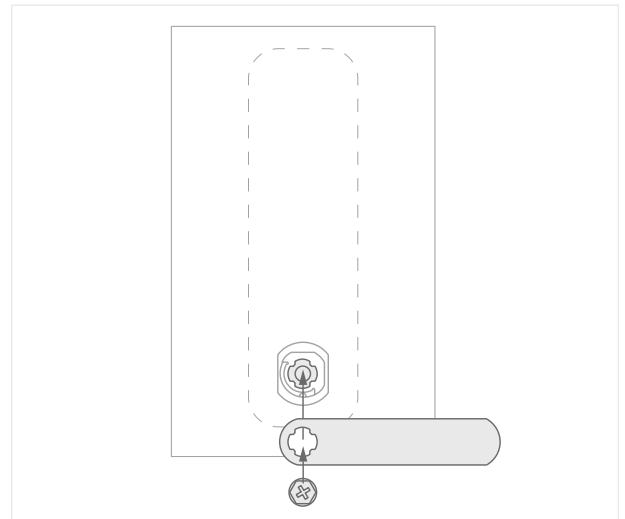

- 5 Then check whether the cam has sufficient hold on the striking plate or the rebate when closed. It should be possible to turn the cam to its end position without pressure or resistance when locking the locking system.

Note: The locking can be optimally adjusted using an adjustable striking plate. For more information, please get in touch with your contact at BURG.

Battery Change

The locking system must be dismantled to change the battery.

- 1 Dismantle the locking system (see page **8** "Assembly"). Remove the screw, nut and rubber seal.

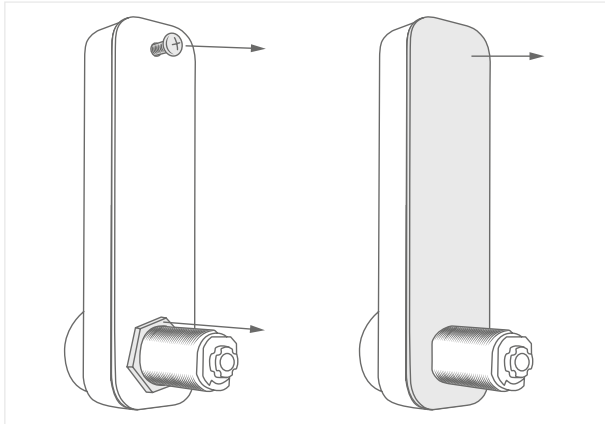

- 2 Replace the batteries according to the (+/-) symbols.

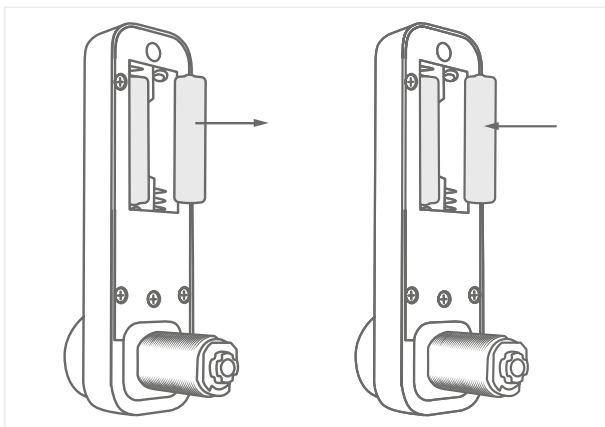

- 3 Replace the rubber seal. Refit the locking system with the nut and screw (see page **8** "Assembly").

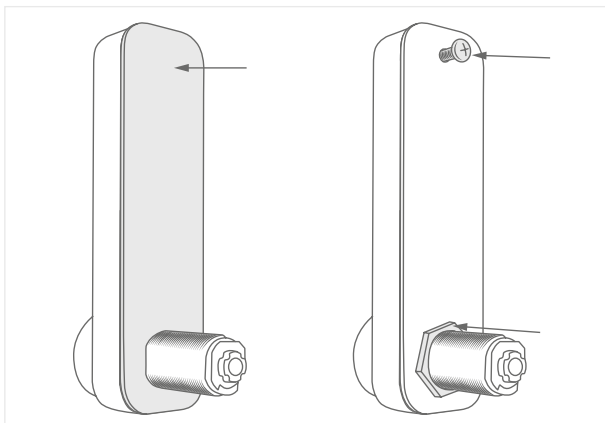

Disposal and Battery Note

EU Directive 2012/19/EU regulates the proper take-back, treatment and recycling of used electronic devices.

Every consumer is legally obliged to dispose of batteries, rechargeable batteries or electrical and electronic devices ("old devices") that are powered by batteries or rechargeable batteries separately from household waste, as they contain harmful substances and valuable resources. They can be disposed of at an approved collection or take-back point, e.g. a local recycling center. Old appliances, batteries and rechargeable batteries are accepted there free of charge and recycled in an environmentally friendly and resource-saving manner. Old electrical appliances, used batteries or rechargeable batteries can also be returned to us. The return shipment must be sent with sufficient postage to the address below. The following symbol on waste electrical equipment, batteries or rechargeable batteries indicates that they must not be disposed of with household waste:



Important notes on the use of batteries:

- The use of high-quality brand batteries is essential for the correct functioning of the locking system. BURG locking systems are approved ex works for the specified industrial batteries of the VARTA brand. The use of batteries of other brands can lead to a reduced number of possible locking cycles as well as to limited functionality and functional problems, as experience has shown that batteries of other brands even with the same specifications have different performance characteristics. BURG does **not guarantee** the functionality of the locking system when using batteries of a brand other than those specified above.
- If both batteries are removed at the same time when changing the batteries or over a longer period of time, settings relating to the integrated real-time clock (RTC) will be lost.
- The battery may explode or release flammable gases if it is handled incorrectly, destroyed or the wrong type of battery is used. Do not recharge the battery, disassemble it, expose it to extremely high temperatures or throw it into a fire. Batteries containing harmful substances are labeled with abbreviations for the substances cadmium (Cd), mercury (Hg) and lead (Pb). If the lock is not used for a longer period of time, the batteries must be removed.

Information on battery life



For online viewing,
click on QR codes.

Conformity / Certification

CE Declaration of Conformity

Hereby, **BURG Lüling GmbH & Co. KG** declares that the radio equipment, type **Niro.RFID**, is in conformity with directives 2014/30/EU, 2014/35/EU, 2014/53/EU and 2011/65/EU. The full text of the EU Declaration of Conformity can be found at the following link:

https://www.burg.de/files/downloads/Declaration-of-Conformity/BURG_DoC_NiroRFID_EN.pdf



Guarantee and Warranty

The warranty is subject to the statutory provisions. If you have any questions, please contact a specialist dealer or use the contact details below. Spare parts can be found at specialist dealers or at: **www.burg.shop**

Cleaning and Care Instructions

Remove the batteries before cleaning the appliance. Carefully clean the surfaces of the appliance with a damp, clean cloth. Chemical cleaning agents must not be used. Do not allow dust or liquids to enter the device.

Contact

BURG Lüling GmbH & Co. KG

Volmarsteiner Str. 52
58089 Hagen (Germany)
+49(0)23 35 63 08-0

info@burg.de
www.burg.de