

## Security and Intelligence in Furniture.

We can do it! With BURG!



Turn knobs



Espagnolette locks



Screw-on locks



Glass door locks



Central locking



Roller shutter locks



Special locks

## A system for all solutions

There is no limit to the combinations and variations. Open to all your requests, ideas and requirements. Choose from a variety of locking systems, decorative items and other accessories. Whether in front or in the interior – everything can be combined.



### Electronics

CodeKnob



E-HS



### Turn knobs

ZDK4.2



DK2.2



### Cylinder cores

ZWK



SWK



### Keys

Standard keys



Folding keys



Track keys



Dimple keys



### Rosettes

SSR.1



SKR1



STR18



### Espagnolette locks

DSD1.15



DSD2



### Screw-on locks

AS1.20.D



AS4.301.R



### Glass door locks

GFT2.1



HZM1.1



### Special locks

HZB.30.X



RJS1



ZVZ2.40



### Lock with falling latch/turn knob/rosette

F51 with DKFS1 with SRFS1



All locks are fitted with a single housing. The base for an intelligent **combination system** for either interchangeable core cylinders or turn knobs in all standard locks.

The single bore diameter of **21 mm** provides maximum flexibility with rotary rod and rim locks as well as turn slide and push cylinders.

A **forced locking system** can be added to standard locks after fitting. The uniform locking angle of 90° immediately shows if the furniture is open or locked.

The BURG furniture locking systems are available for **left or right hand** installation, reversible even after installation.

## The “Burg process”.



### Getting to know each other

At this point, you get to know us: as a versatile partner for product-specific solutions. As a creative collector of ideas for the individual requirements of our customers. And as competent experts who do not hastily give up on a project.



### Advising

Is this OK, or is it better the other way? Working together with you, we develop solutions to expand product features, for value-added strategies and to achieve an increase in efficiency.



### Supporting

We would like to be more than just your supplier. That's why we also look at available products and processes and define goals for product optimisation. Because you should also be able to benefit from our expertise.



### Research and development

Those who already know a lot are always hungry to learn more: the creativity of our design engineers is at your disposal, so that your project is ergonomically optimised and pleasing to the touch, with good design through clear use of form; with the implementation of new materials for the best technical solution, and with approaches that go beyond pure mechanics, all with a clear goal: Innovation.

### Production

Our production is definitely worth having a look at. Leading edge equipment, high manufacturing standards and a comprehensive quality assurance procedure ensure that your orders are completed reliably. And by the way, this doesn't only apply to locking systems! With our competence in zinc die-casting we are also at your disposal in other areas.



### Mounting

What comes out of the machine is by no means finished. We also undertake the finishing process, for example, the final assembly of pre-assembled components. And the process is completely personalised and adapted to your projects.



### Logistics

Low stock levels and yet no supply shortfalls? Here you can rely on us. Because just-in-time delivery, kanban system and supply chain management are not simply buzzwords to us; they are part of our daily routine.



### After sales

Even after delivery, our job is not finished. Now is when our work really starts! Because by sharing experiences with you and by working together with you to consider how better to optimise the marketing and commercialisation, the term 'supply partner' takes on a much more complex meaning.



### Customer satisfaction

The goal is achieved – and motivation for the next round? Because for us, at any rate, it is worth making all that effort when we receive positive reaction from our customers about our work.



# Take convenience and security into your own hands.

## CodeKnob: the multi-functional "stand-alone" code locking system

The code replaces the key and can be individually adjusted by the user. The programming is simple and is done via the active surfaces at the front. A translucent ring confirms the right code in green and red indicates an input error.

Product examples



CodeKnob



CodeKnob Aluminium



## E-HS: the new generation of electronic lever locks

The entire electronics and the new and innovative release mechanism is integrated into the lock. Instead of a lifting magnet, the system is controlled through a 4.5 V miniature engine, which powers a gearwheel via miniaturised gears, thus joining the knob and the lock. Ideal for refitting and retrofitting.

Product example



E-HS

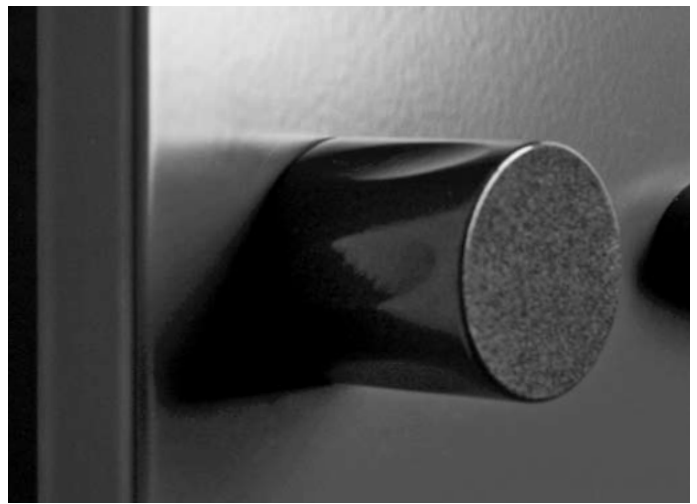

## The innovative TouchCode combination lock with individual coding

The user closes the door with the knob, enters his individual code using the membrane keypad and then confirms the entry. This secures the door until the user enters the code again. LEDs show the operational status. The code can only be confirmed if the door is closed and the knob is in the "Closed" position. There is an emergency opening function. The flat design is ideal for installation in furniture (wood and steel).

Product example



TouchCode

**The TouchCode has been designed for secure use for many applications, for example:**

- in cabinets for employees
- in swimming pools
- in hotels
- in the cloakrooms of public buildings.



An overview of our furniture locking systems can be found on the internet at: [www.burg.de](http://www.burg.de)

## Furniture locking system turnaround: The BURG rotating and furniture knobs.

### Cylinder turn knobs

Nice and firm. The tried-and-tested cylinder turn knobs are made from hard-wearing zamak and meet modern design standards. Independent of the design of the knob: the cylinder turn knobs can be fitted with any BURG furniture lock.

### Product examples



ZDK2.2



ZDK4.2

### Turn knobs

Just twist and open. The popular turn knobs are of course also available without integrated furniture lock. In this case, the "missing" cylinder core is covered using a suitable cap. How about a design that matches your corporate identity?



DK1.2



DK2.2

### Fixed knobs

Anyone will be happy to lend a hand. The fixed knobs come in the same designs as the rotating knob range. They thus blend in perfectly with your furniture range – and can be easily refitted and retrofitted.



BK3.2



BK6.995

### Please note:

All designs pictured here are product examples and available as cylinder rotating knob or dummy knob. For more models, please go to [www.burg.de](http://www.burg.de).

An overview of our furniture locking systems can be found on the internet at: [www.burg.de](http://www.burg.de)

# New furniture ideas: Under lock and key.

## Espagnolette locks

Locking and opening up again – with the lock guarantee at up to 3 places of the cupboard door at the same time. The BURG rotating espagnolette locks can be combined in many different ways, from lock and bar diameter to the hook. Backset vary between 15, 20, 25 and 30 mm and even up to 38 mm with the DSD2 model.

### Product examples



DSD1.15\*



DSD3.15\*



DSD2\*

\* Available with screws  
or plugs

## Screw on locks

The furniture classic. The tried-and-tested BURG screw on lock scan be easily integrated into the furniture. Round or angular: with backset of 20, 25 and 30 mm, they secure the content of cupboards and drawers.

### Product examples



AS1.20.D



AS4.301.R

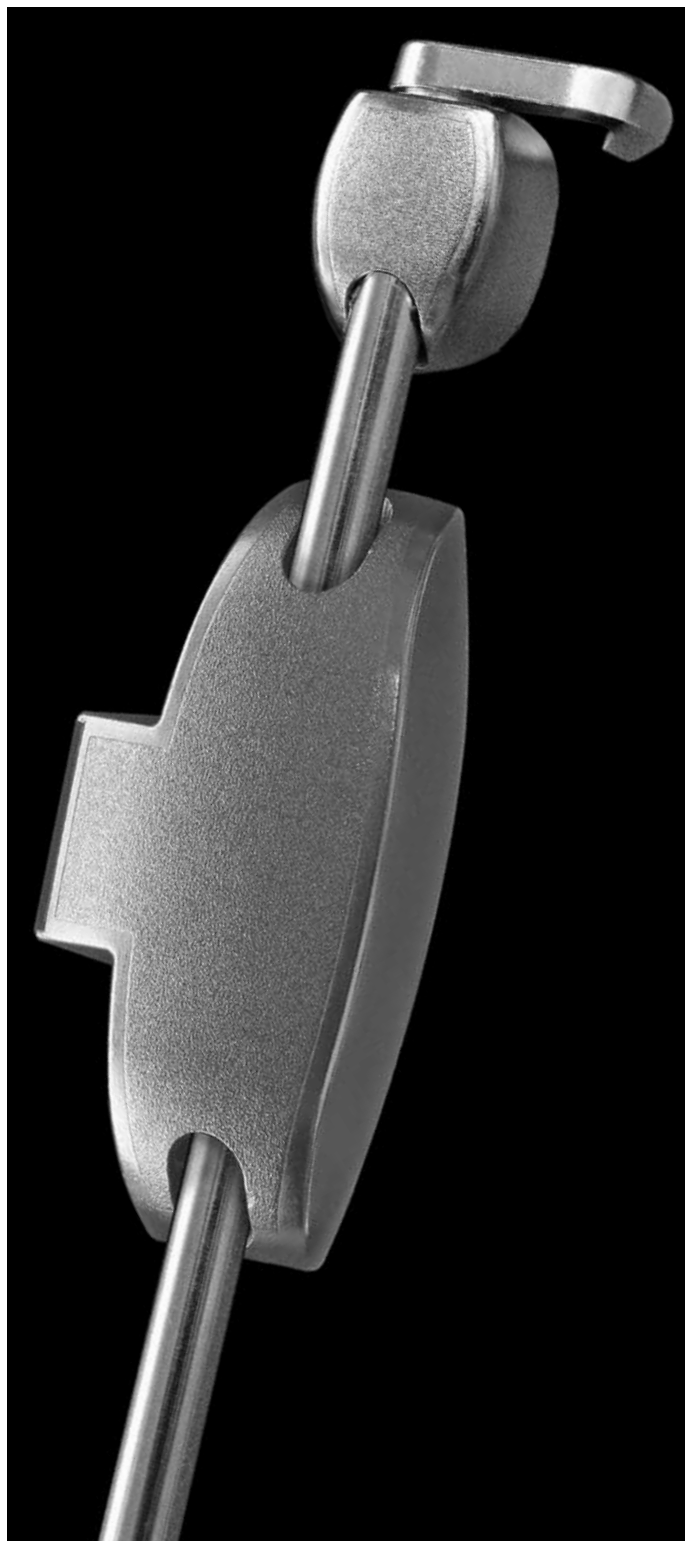

An overview of our furniture locking systems can be found on the internet at: [www.burg.de](http://www.burg.de)

## Safety that does not need to be hidden away!

### Glass door locks

The most beautiful pieces are best showcased in a display cabinet. The BURG glass door locks meet the highest security and design standards with their discreet lock bolt. They allow you to have a look without disclosing too much of the cabinet's inner values. A stylish and modern eye-catcher.

### Wing doors

For display cabinets that stylishly open on both sides. The button cylinder, which can be used on one side only, has a sprung bolt that ensures additional convenience when locking the cabinet. The level cylinder lock is anchored using a stop plate in glass up to 8 mm thick and creates a perfect visual closure.

### Product examples



GFT2.1



HZM1.1

### Sliding doors

Simply slide the glass pane to the left or to the right – and the display cabinet is open. But what do you need in order to keep the sliding door reliably locked? The BURG sliding door lock system is built into the aluminium profile of the glass. The roller cylinder is suitable for locking on the left and right, thus providing new furniture design options.

### Product example



GST4

### Display cabinet lock accessories

Clear as glass: BURG has the right accessories for all furniture designs. Combinations with various stop plates and adapter rings complement the wide range of glass door locks, forming the basis for a great number of different variations.



An overview of our furniture locking systems can be found on the internet at: [www.burg.de](http://www.burg.de)

## Many different options

### ZVS central locking system with safety stop – innovative and reliable

The convenience and safety of the newly developed BURG central locking system is now available as an innovative product for wooden furniture. The security is based on the high-quality mechanical function, and the convenience aspect on the reliability and day-to-day ease-of-use. Suitable for cupboards with up to 8 drawers, in spacing 25 mm and 32 mm.

#### Product example

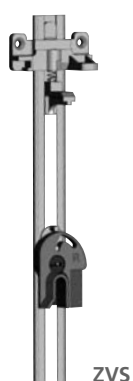

Locking system aligned to the new central locking bar.

## BURG has the right thing for designers who are into heavy metal

### Steel furniture locks

Designers turn cold steel into cool furniture. And we safeguard this development in the long run – with locks and locking systems specially developed for metal and metal design. Screws or brackets: the strong steel furniture locks can be locked to the left or right, top or bottom – ideal for wing doors, drawers and wall units.

#### Product examples



HZH.30



HZM.17



Turn knob for steel furniture.

An overview of our furniture locking systems can be found on the internet at: [www.burg.de](http://www.burg.de)

Our company specialises in locks for home and office.

### Push cylinder and push- and turn-slide cylinder

Little effort, great impact. These popular push cylinders and push- and turn-slide cylinders have many different uses – e.g. for elegant sliding doors in office, living rooms and bedroom furniture. Specially designed and custom-made rosettes create additional design elements.

#### Product examples



DZ

### Cylinder cam locks

The classic furniture lock for cupboards, drawers and all other applications. It can be assembled to lock on the right or left, at the top or bottom. There are countless design and functionality options.



HZB.30.X

### Roller shutter locks

Blinds are an integral part of modern furniture design. And of course we do all we can to secure this mechanism. Our roller shutter locks work leftward as well as rightward and some of them have a continuous lock measure. The RJS2 model with double hook bolt for double effect blinds is additionally protected by an attractive SWR closing plate!



RJS1



RJS2-SWR2

### Central locks

These lock systems are extremely versatile. The two-sided flange ensures great assembly stability, the different tappet lengths can be used for various different material strengths. The central locks are particularly useful in combination with the locking rods with drive bolt.

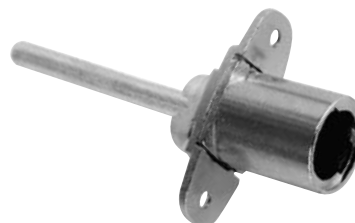

ZVZ2.40

An overview of our furniture locking systems can be found on the internet at: [www.burg.de](http://www.burg.de)

# The most beautiful irrelevance in the world. Accessories that look good on all furniture.

## Cylinder cores

The heart of all knobs and handles that can be assembled separately. Up to 2,000 different types of locks with the popular 6-disk bolt. Ideal for fitting furniture with security technology.

### Product examples



ZWK



SWK

## Keys

Every lock needs a key. And keys are available in many different popular versions such as with a flexible plastic cap in many different colours. We can of course produce custom-made colours, shapes and embossing (e. g. a company logo).

### Product examples



Standard keys



Folding keys



Track keys



Dimple key

## Rosettes

Functionality meets design. The rosettes made from zamak perfectly balance the look of the furniture. They are available gold-plated, as well as in many colours and individual designs.

### Product examples



SSR.1



SKR1



STR18



An overview of our furniture locking systems can be found on the internet at: [www.burg.de](http://www.burg.de)

Perfection to the last detail.  
Because everything fits together.

### Rotary rods, push rods, bar guides

Matching the BURG rotary espagnolette locks, these locks securely lock any cupboard door in several areas. With diameters of 6/5 and 8/7, these rods are made of nickel-plated steel and go with all furniture designs.

#### Product examples



DS6 & DS8



HRST

### Espagnolette locks, hook, angular striker plate

Topping the rotary rod. We are, of course, talking about the hooks that keep your cupboard doors reliably locked. Various locking bolts can be easily positioned in the corpus for secure locking through the hook (as in model SHD.L).

#### Product examples



SB01



SHD.L



SW3

### Bar guides

Guaranteed guiding. Made from nickel-plated zamak, the bar guides, including plastic inserts, secure the rails of 6/5 and 8/5 rotary rods and 10/3 half rods.

#### Product examples



ZFH



ZFS6



An overview of our furniture locking systems can be found on the internet at: [www.burg.de](http://www.burg.de)

The complete BURG range,  
technical information and examples  
of customer-specific solutions  
can be found at **www.burg.de**

#### Products

- Electronic controls
- Combination locks
- Cam locks
- Handle systems
- Sash locks
- Padlocks
- Central locks
- Coin deposit locks
- Glass door locks
- Push and Turn-slide cylinders
- Industrial cylinders
- Components and accessories
- Cabinet locks

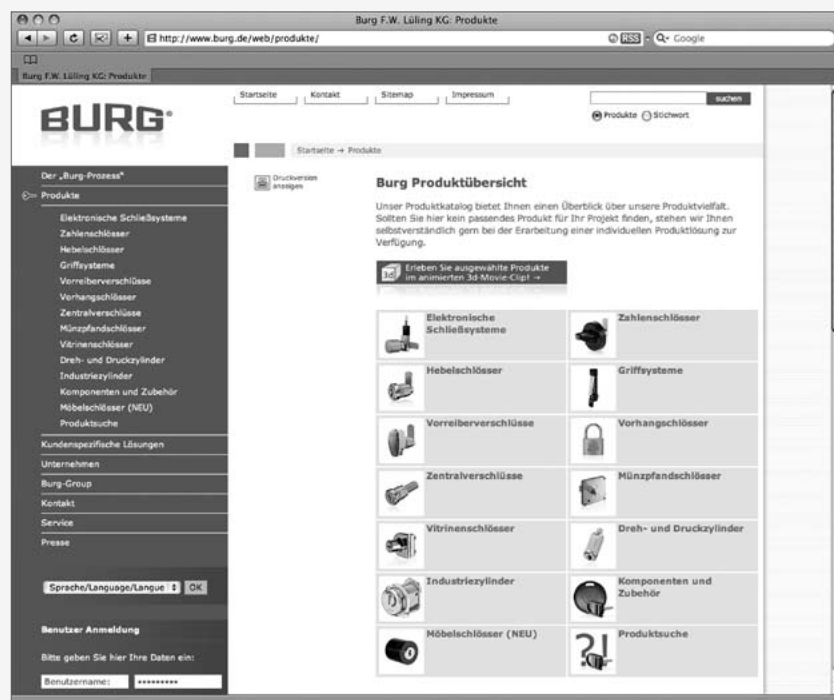

Distributore esclusivo in ITALIA:

**TECSAL SRL**

Via Lazzarin 66 • 31015-Conegliano (TV) • Sede Operativa in via del Lavoro 69 – 31013 Codogné (TV)

Tel. +39 (0) 438/47 16-09 • Fax +39 (0) 438/47 16-49 • vendite@tecsal.it • www.tecsal.it

**BURG** F. W. Lüling KG

Postfach 148 • D-58289 Wetter (Germany) • Hegestraße 6–16 • D-58300 Wetter (Germany)

Fon +49 (0) 23 35/63 08-0 • Fax +49 (0) 23 35/63 08-999 • info@burg.de • www.burg.de